

# ALVARADO

## SLT Slim Line Waist High Turnstile

---



### Technical Specifications

<b>Dimensions</b>	<u>Unit Height:</u>	39.875" (1013 mm)
	<u>Unit Width:</u>	23.25" (591 mm)
	<u>Unit Depth:</u>	19.875" (505 mm)

<b>Materials</b>	<u>Cabinet:</u>	Formed and welded 12 gauge cold rolled steel. All exterior welds are ground smooth and polished.
	<u>Base Plate:</u>	0.25" thick cold rolled steel and welded to the base of the cabinet assembly. Three holes are provided in the base plate to allow the turnstile to be anchored.
	<u>Lid:</u>	Formed and welded 14 gauge stainless steel. The lid is mounted to the cabinet with a minimum of two self tapping screws.
	<u>Head:</u>	Solid piece of aluminum, machined to an attractive conical shape and drilled to accept the three turnstile arms. The arms are press fit into the head and welded from the back. There are no exterior fasteners.
	<u>Arms:</u>	1.5" OD x 16 gauge stainless steel tubing. The arms are sealed at one end by a stainless steel cap welded and ground smooth. When at rest, the arms create a 90-degree passageway so that the arms do not impair the patron passageway. The arms are polished to a #4 satin finish. The arms extend 15.5" from the inside edge of the cabinet.

All tubing and sheet metal materials meet ASTM Standard A513.

<b>Function</b>	The SLT is a manual, waist high three arm turnstile designed to provide quick and effective patron throughput and counting. An electric locking control version of the SLT, the SLTX, is also available for controlled access applications.
-----------------	---

<b>Available Configurations</b>	The following configuration of the SLT is available:
---------------------------------	--

<b>SLT-3</b>	Using key lock control, the SLT can be configured to provide free passage in both directions; free passage in one direction and restricted passage (locked) in the opposite direction; or restricted passage (locked) in both directions.
--------------	---

<b>Interior Components</b>	<u>Ratchet Assembly:</u>	Precision investment cast stainless steel and machined, hardened steel parts.
	<u>Roller Bearing Assembly:</u>	Six precision roller bearings that ride on a precision investment cast stainless steel cam to provide precise and smooth one way or bi-directional rotation.
	<u>Hydraulic Dampening Assembly:</u>	Provides a smooth braking effect during the rotation of the turnstile to eliminate "rumpslap" and over rotation of the turnstile arm. It also automatically self centers the arms to the "home" position. The hydraulic dampening tension is adjustable.
	<u>Mechanical Turnstile Control:</u>	The locking and unlocking of the unit is controlled with stainless steel lock arms that are moved into the appropriate locked or unlocked position by mechanical key overrides and spring assemblies. There is one key override and spring assembly per lock arm, and one lock arm per direction, allowing the operating technician to mechanically lock or unlock one or both directions of the SLT turnstile. Separate key

overrides are provided for each direction of travel and are located near the arms on the cabinet fascia.

<b>Available Finishes</b>	<b>Powder Coated</b>	Available in a wide variety of colors. Sub-assemblies are sand blasted to prepare for the powder coating finish. The powder is electrostatically applied, then baked to assure proper curing and adhesion. Normally the stainless steel lid, the aluminum head, and the stainless steel arms are not powder coated.
	<b>Stainless Steel</b>	The cabinet is fabricated from #304 stainless steel.
<b>Shipping Details</b>		SLT turnstiles are fully assembled in a solid, fully enclosed, wooden crate. Each SLT unit includes mounting hardware (anchors, bolts, washers, etc.) to install the turnstile into a concrete base. Alvarado ships products throughout the world.
<b>Installation Details</b>		All SLT units must be installed on a firm foundation. The recommended platform is 4" deep, level concrete. No embedded fasteners are needed for installation. Installation should be performed by a skilled installer following the manufacturer's directions and instructions (supplied with the turnstile).
<b>Approximate Weight</b>		Approximately 120 lb. (54 Kg) per cabinet

## Options

### Counter

A lithium battery powered LCD seven digit counter is installed in the turnstile. Each rotation of the turnstile arm generates a count. One counter is required per direction of travel. Counters can be ordered as resettable or non-resettable. Resettable counters can be reset to "0" using a provided key. Non-resettable counters cannot be reset.

### Computerized Counting

Each turnstile rotation outputs a count to GateWatch, Alvarado's Windows based software program that monitors and records real time patron counts.

### Portable Base

The turnstile is affixed to a black powder coated steel diamond plate base with a guide rail. Castors to move the turnstile are affixed to the back of the base plate.

### Electric Lock Control Upgrade

The SLT is convertible to an electric lock control unit with the addition of electrical components. The required brackets and insertion holes are included in the SLT unit to allow for easy field retro fitting.

### Attached Ticket Drop Box

A drop box for ticket collection is mounted to the turnstile cabinet.

## SLT Site Preparation

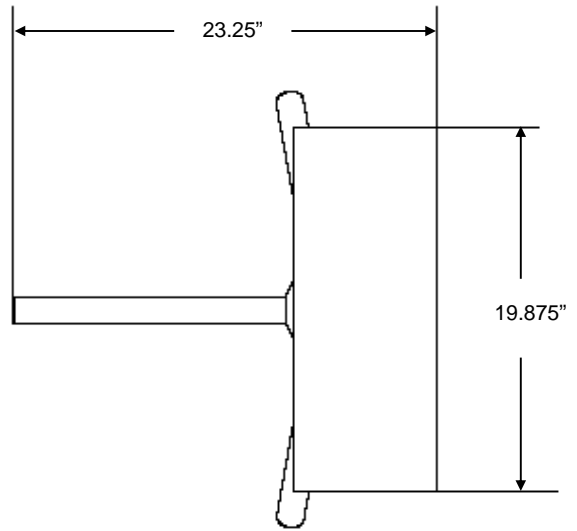
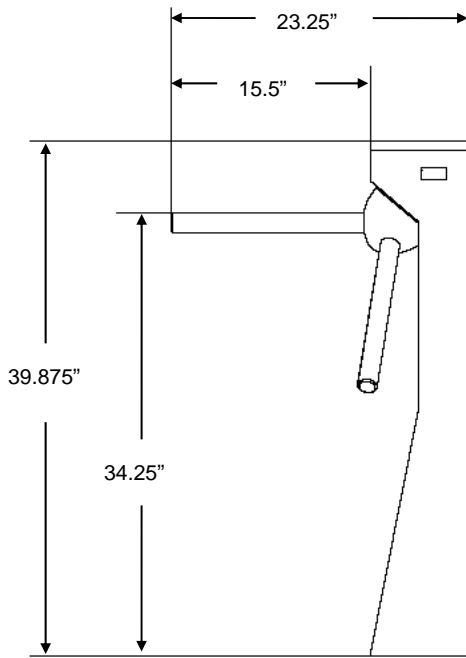

Note: Allow a 2" clearance gap between the end of the turnstile arm and the next unit or outside barrier.

## Footprint Drawing

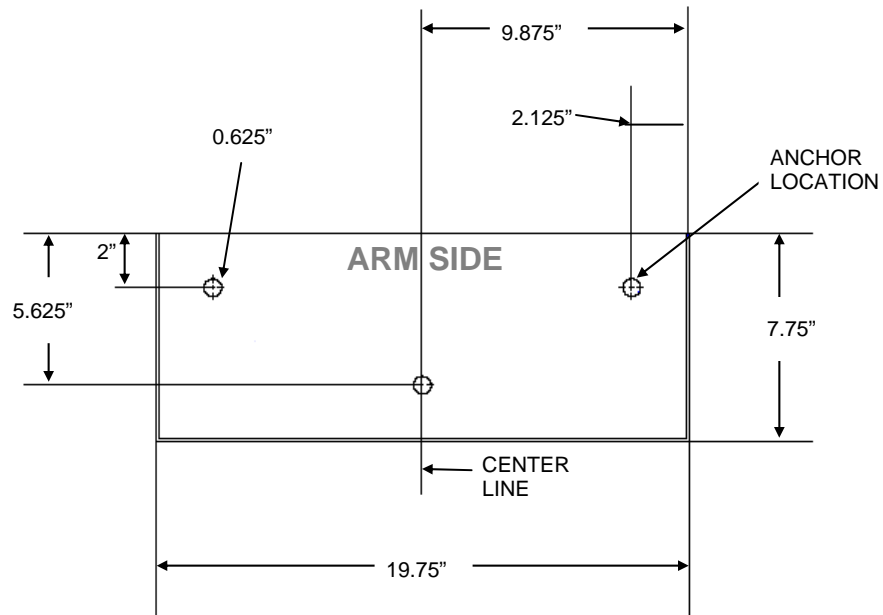

## Slab Requirements

- Minimum thickness: 4" level sold concrete

## Warranty

Alvarado Manufacturing Co., Inc. warrants the SLT, from defects in material or workmanship, for the period of ONE YEAR from date of shipment. Complete details of the warranty are available from Alvarado by request.

## Technical Services

Technical information is available from Alvarado Manufacturing Co., Inc., and its representatives, distributors, and dealers.

# ALVARADO

Alvarado Manufacturing Company, Inc.  
12660 Colony Street  
Chino, CA 91710

Telephone (909) 591-8431  
Toll Free (800) 423-4143  
Fax (909) 628-1403

[www.alvaradomfg.com](http://www.alvaradomfg.com)